



HERITAGE NEW ZEALAND  
POUHERE TAONGA

Short Review Report  
**Quarry, OTEKAIEKE (List No.5664)**

---



View of quarry site 5664. Dr Matthew Schmidt, Heritage New Zealand, 1 June 2018.

---

Sarah Gallagher  
28 Jan 2020  
Heritage New Zealand Pouhere Taonga

## **TABLE OF CONTENTS**

<b>1.</b>	<b>IDENTIFICATION</b>	<b>3</b>
<b>2.</b>	<b>REASONS FOR DISCONTINUING / REMOVING THE ENTRY FROM THE LIST</b>	<b>3</b>
<b>3.</b>	<b>ATTACHMENTS</b>	<b>5</b>

## 1. IDENTIFICATION

<b>List Number:</b>	5664
<b>Name:</b>	Quarry
<b>Address:</b>	E 1403481 N 5032456
<b>Legal Description:</b>	Sec 114A Otekaieke Settlement Maerewhenua SD (RT OT14A/1142), Otago Land District
<b>List Entry Details:</b>	<p>Quarry was registered as an archaeological site under Section 43 of the Historic Places Act 1980 in 18 Apr 1985 and given List Number 5664. The owner was notified in writing of the registration on 18 Apr 1985. Quarry was automatically deemed to have final registration status as a Category II historic place under the transitional provisions of the Historic Places Act 1993 (HPA 1993). Letter notifying registration is in File 11014 023.</p> <p>See attached letter.</p>
<b>Confirm Identity:</b>	The listing was checked against the NZAA record for (I40/39)
<b>Protection:</b>	NOT FOUND in Waitaki District Plan, Operative 31 May 2010.

## 2. REMOVING THE ENTRY FROM THE LIST

<b>Summary:</b>	<p>The site is located between the Ōteake / Otiake River and the Ōtekaieke River which are named for tīpuna who were passengers on the Ārai-te-uru waka that capsized off Matakaea (Shag Point) on the Otago coastline. The tīpuna never returned to the waka after exploring inland and were transformed into geological features.<sup>1</sup></p> <p>The Waitaki River was an ara tawhito (traditional travel route) for Kāi Tahu into the interior of Te Wai Pounamu and there are many kāika nohoaka (seasonal settlements), kāika mahika kai and kāika mahika toi (food and cultural resource gathering sites) along the river.<sup>2</sup> It is additionally a significant area where rock art taonga are found.<sup>3</sup></p>
-----------------	---

<sup>1</sup> Kā Huru Manu <http://www.kahurumanu.co.nz/atlas> accessed 28 Jan 2020.

<sup>2</sup> <https://ngaitahu.iwi.nz/ngai-tahu/the-settlement/settlement-offer/cultural-redress/ownership-and-control/mahinga-kai/>.

<sup>3</sup> Ngai Tahu Settlement. Deed of Recognition for Waitaki River, Otago. 16 Oct 1988, <https://www.beehive.govt.nz/feature/ngai-tahu-settlement-171> accessed 28 Jan 2020.

	<p>Silcrete outcrops were a source of stone to make flakes and blades used as cutting tools. Most quarries were small (300m<sup>2</sup> to 2000m<sup>2</sup>). The greatest concentration of silcrete and porcellanite in Otago is in a broad band from Nenthorn to the Manuherikia Valley. Archaeologist Atholl Anderson reported there were 30 silcrete quarries and 15 porcellanite quarries for Otago, Southland, and South Canterbury. The main tools were flakes and blades, both struck from quarried cores.<sup>4</sup></p> <p>This archaeological site (I40/39) was visited by Dr Matthew Schmidt (archaeologist HNZPT) and Dr Tim Thomas (archaeologist specialising in silcrete tools and quarries, University of Otago) on 1 June 2018. There was no evidence of any quarrying found. Drs Schmidt and Thomas do not consider this an archaeological site, rather a natural outcrop. The whole surrounding area was thoroughly searched to ensure sites were not missed as a result of historic mapping conversion errors.</p> <p>The site has not been noted as having particular cultural importance in any of the web and written resources searched during this assessment.</p>
Reasons:	<p>The investigation into this place has indicated that there is insufficient evidence to support entry on the New Zealand Heritage List/Rārangī Kōrero ('the List') under the criteria defined in Section 66 of the <i>Heritage New Zealand Pouhere Taonga Act 2014</i>. There is no evidence of quarrying on which grounds the site was entered on to the List.</p> <p>For this reason, it is proposed that this place is removed from the List.</p>
Team and Manager Response:	<p>The Otago/Southland team and Area Manager were informed in August 2019 of the proposal to remove this place from the List and are in agreement that it should be removed. The Otago/Southland Pouarahi Huia Pacey was consulted on 19 February 2020, and she is in agreement with this assessment.</p>
Author:	Sarah Gallagher
Date:	20 February 2020

---

<sup>4</sup> Quartzite Silcrete Working Floor List no. 5619

### 3. ATTACHMENTS

#### List Entry Report

<b>List Entry Record</b>		<b>HERITAGE NEW ZEALAND POUHERE TAONGA</b>
List Number: 5664	Site Reference: P6130	

<b>Name:</b>	Quarry		
<b>Other Names:</b>	<b>Name</b>	<b>Year From</b>	<b>Year To</b>
<b>Location:</b>			
<b>List Entry Legal Description:</b>	Sec 114A Otakāke Settlement Māerewhenua SD		
<b>Local Authority:</b>	Waitakī District		
<b>Summary:</b>			
<b>List Entry Status:</b>	Listed		
<b>List Entry Type:</b>	Historic Place Category 2		
<b>List Number:</b>	5664		
<b>Date Entered:</b>	18 April 1985		
<b>Extent of List Entry:</b>			
<b>Chattels</b>			
<b>District Plan Listing:</b>	District Plan	NOT FOUND in Waitakī District Plan, Operative 31 May 2010.	
<b>NZAA Site Number:</b>	140/39		
<b>Maori Interest:</b>	Unknown		
<b>Heritage NZ Office:</b>	Otago/Southland Office		
<b>Other Information:</b>	Please note that entry on the New Zealand Heritage List/Rarangi Korero identifies only the heritage values of the property concerned, and should not be construed as advice on the state of the property, or as a comment of its soundness or safety, including in regard to earthquake risk, safety in the event of fire, or insanitary conditions.		
<b>General Nature of Wahi Tapu:</b>			
<b>Section 66(1) &amp; 66(3) Assessment:</b>	Section 23(1)	Registered under previous legislation (HPA 1980)	
	Section 23(2)	Registered under previous legislation (HPA 1980).	
<b>Section 66(1) Detail:</b>			

Location Map

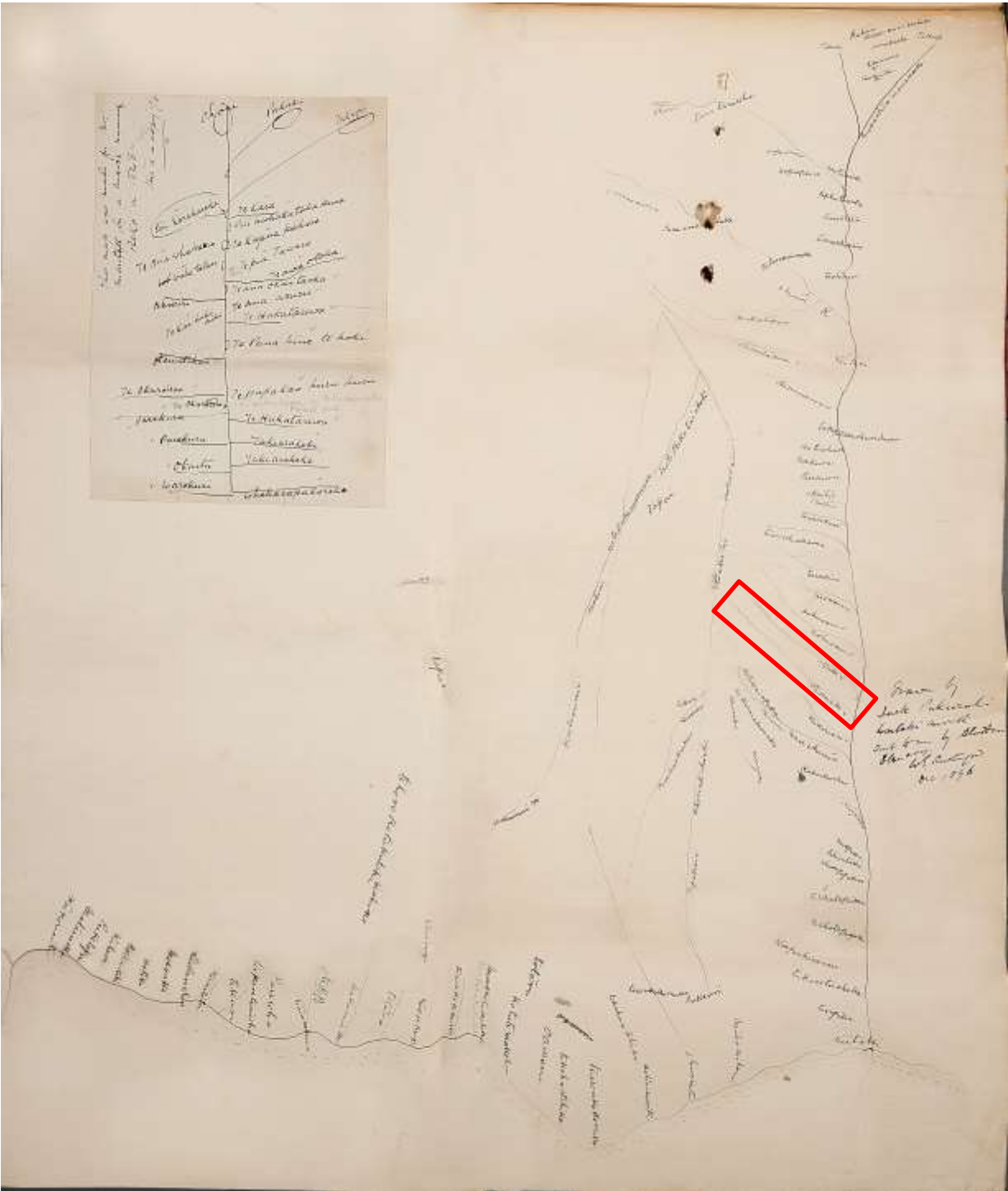

Figure 1: Map of Māori place names in the Waitaki catchment drawn by Tieke Pukurākau, 1896, TPC02 : Tieke Pukurākau Collection : Ngāi Tahu Archive, <https://kareao.nz/>.





Figure 2: Detail from Herries Beattie Map of Māori Place Names in Otago and Southland, c 1930, James Herries Beattie Collection, Ngāi Tahu Archive, <https://kareao.nz/>.



Figure 3: screenshot from Kā Huru Manu showing the placement of the site between the two tīpuna awa (rivers), <http://www.kahurumanu.co.nz/atlas>.



Figure 4: Screenshots from Pātaka at different scales. List No. 5664 indicated by the red marker and the correct location indicated by the ARCHSITE coordinates and number I40/39 circled in blue.



NEW ZEALAND ARCHAEOLOGICAL ASSOCIATION



 <p><b>Summary Site Record</b></p>	<p><b>NZAA SITE NUMBER:</b> I40/39</p> <p><b>SITE TYPE:</b> Source site</p> <p><b>SITE NAME(s):</b></p> <p><b>Record last updated:</b> 01/01/1984</p>
<p><b>SITE COORDINATES (NZTM)</b> Easting: 1403481      Northing: 5032456      Source: CINZAS</p>	
<p><b>IMPERIAL SITE NUMBER:</b> S127/127      <b>METRIC SITE NUMBER:</b> I40/39</p>	
 <p>Scale 1:2,500</p> <p>Land Information New Zealand - Eagle Technology</p>	

Figure 5



**RECORD OF TITLE  
UNDER LAND TRANSFER ACT 2017  
FREEHOLD  
Historical Search Copy**



Constituted as a Record of Title pursuant to Sections 7 and 12 of the Land Transfer Act 2017 - 12 November 2018

**Identifier** **OT14A/1142**  
**Land Registration District** **Otago**  
**Date Issued** 14 February 1992

**Prior References**  
 OT5C/1105

---

**Estate** Fee Simple  
**Area** 170.3690 hectares more or less  
**Legal Description** Section 113A and Section 114A Otekaieke Settlement

**Original Registered Owners**  
 Mt Otekaieke Station Limited

**Interests**

- Subject to Section 3 Petroleum Act 1937
- Subject to Section 8 Atomic Energy Act 1945
- Subject to Section 3 Geothermal Energy Act 1953
- Subject to Section 6 Mining Act 1971
- Subject to Section 8 Mining Act 1971
- Subject to Section 5 Coal Mines Act 1979
- Subject to Section 261 Coal Mines Act 1979
- Subject to Part IV A Conservation Act 1987

770992.13 Mortgage to Geoffrey Franklin Bishop and to Geoffrey David Bishop and to Geoffrey Franklin Bishop, Leone Isabel Bishop and Neville John Langrish in shares - 17.1.1991 at 10.02 am

848073.1 Transfer creating the following easements - 3.2.1994 at 9.23 am

Type	Servient Tenement	Easement Area	Dominant Tenement	Statutory Restriction
Convey water	Section 113A and Section 114A Otekaieke Settlement - herein	h Transfer 848073.1	Section 115A Otekaieke Settlement - CT OT6C/111	
Convey water	Section 113A and Section 114A Otekaieke Settlement - herein	i Transfer 848073.1	Section 115A Otekaieke Settlement - CT OT6C/111	
Convey water	Section 113A and Section 114A Otekaieke Settlement - herein	j Transfer 848073.1	Section 115A Otekaieke Settlement - CT OT6C/111	
Convey water	Section 113A and Section 114A Otekaieke Settlement - herein	k Transfer 848073.1	Section 115A Otekaieke Settlement - CT OT6C/111	
Convey water	Section 113A and Section 114A Otekaieke Settlement - herein	l Transfer 848073.1	Section 115A Otekaieke Settlement - CT OT6C/111	

Transaction Id 59574283  
 Client Reference agallagher001

Historical Search Copy Dated 28/01/20 11:12 am, Page 1 of 2

References

Prior C/I 5C/1105

Transfer No.

N/C Order No. 798199

Land and Deeds 69



REGISTER

No. 14A/1142

CERTIFICATE OF TITLE UNDER LAND TRANSFER ACT

This Certificate dated the 14th day of February one thousand nine hundred and ninetytwo under the seal of the District Land Registrar of the Land Registration District of OTAGO

WITNESSETH that LANDCORP INVESTMENTS LIMITED at Wellington

is seized of an estate in fee-simple (subject to such reservations, restrictions, encumbrances, liens, and interests as are notified by memorial underwritten or endorsed hereon) in the land hereinafter described, delineated with bold black lines on the plan hereon, be the several admeasurements a little more or less, that is to say: All that parcel of land containing 170.3690 ha more or less being Sections 113A and 114A Otekaieke Settlement situated in Blocks XII and XIII MAEREWHENUA SURVEY DISTRICT.

Interests at date of issue:

Deferred payment licence embodied in the Register of Vol 5C Folio 1105

MERGED

See T...

ALR

ASSISTANT LAND REGISTRAR

Subject to Section 3 of the Petroleum Act 1937, Section B of the Atomic Energy Act 1945, Section 3 of the Geothermal Energy Act 1953, Sections 6 and 8 of the Mining Act 1971 and Sections 5 and 261 of the Coal Mines Act 1979

The within land is subject to Part IVA of the Conservation Act 1987

A.L.R.



Area = 170.3690 ha

OVER...

SCALE 1:15,000 approx  
Measurements are Metric  
SQ 8311

Register open for L.A. & D. 48, 71, 73

No. 14A/1142

Letter

IN

HP 12/11/3  
18 April 1985

Mr G.F. and Mrs L.I. Bishop  
9K  
R.D.  
OMARU

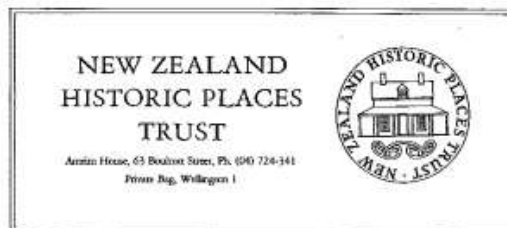

Dear Mr and Mrs Bishop

HISTORIC PLACES ACT 1980: REGISTRATION OF ARCHAEOLOGICAL SITE

1. The Historic Places Act 1980 requires the New Zealand Historic Places Trust to establish a Register of Archaeological Sites. Sites now being registered are selected from entries in the New Zealand Archaeological Association's site recording scheme but others will also be added as a result of future site location and recording programmes initiated or supported by the Trust.
2. The Act (Sections 43-48) extends its protection to all archaeological sites in New Zealand REGARDLESS OF WHETHER OR NOT THEY ARE REGISTERED. The act of registration places no additional duty or encumbrance on land owners or occupiers. Notification of registration is given to ensure an awareness of the presence of a site and the protection that the Act offers to archaeological sites.
3. You are now notified, under Section 43 of the Historic Places Act 1980, as owner/occupier of the land described as:  
Section 114A, Otekaike Settlement, Maerewhenua Survey District  
that this land contains the following archaeological sites, now registered by the Historic Places Trust ...

SITE NUMBER	BRIEF DESCRIPTION OF SITE
I40/39	Silcrete quarry
I40/40	Silcrete quarry
I40/58	Silcrete quarry

and comprised in certificates of title ... 5C/1105
4. The attached papers show the location of the sites and the title to the land on which it is situated. Further explanatory information is also attached.
5. Any enquiries regarding this registration or the administration of the Historic Places Act 1980 should be made to the Director, New Zealand Historic Places Trust, Private Bag, Wellington.

Yours faithfully

for Director



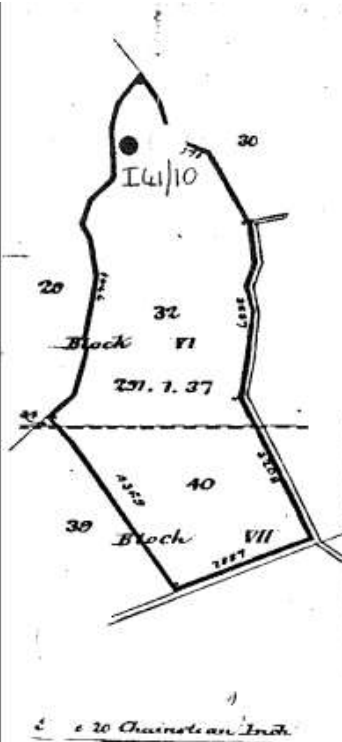

113' 57"

**THE FIRST SCHEDULE HEREINBEFORE REFERRED TO.**

*Description of the Demised Land and Plan.*

All that area in the said District of Otago Colony of New Zealand, containing by admeasurement one hundred and thirty one (131) acres one (1) rood and thirty seven (37) poles more or less being sections numbered respectively thirty two (32) Block VI and forty (40) Block VII Staruawera District comprising part of the 'Wharariki' Block as the same is delineated herein edged red.

**THE SECOND SCHEDULE HEREINBEFORE REFERRED TO.**

*Buildings now existing on the Demised Land and their Capital Value.*

Buildings.	Capital Value.		
	£	s.	d.
Total capital value	£		

*Instalments by which such Capital Value (with Interest thereon) is payable, and the due dates of such Instalments.*

By \_\_\_\_\_ half-yearly instalments of \_\_\_\_\_ each, in advance, in respect of interest alone, and then \_\_\_\_\_ half-yearly instalments of \_\_\_\_\_ each, in advance, in respect of combined capital and interest, the first instalment (being for the half-year commencing on the first day of \_\_\_\_\_, one thousand \_\_\_\_\_), having been duly paid, and the subsequent instalments being payable on the first day of \_\_\_\_\_ and the first day of \_\_\_\_\_ in each year in the same manner as rent.

VALENT METRIC  
IS 117.9523 ha

**THE THIRD SCHEDULE HEREINBEFORE REFERRED TO.**

*Improvements now existing on the Demised Land and their Value.*

Improvements.	Value.		
	£	s.	d.
Buildings, as specified in Second Schedule hereto			
Boundary fencing 150 chains post standard and wire	30		6
Total value	£	30	6

(\*) Specify other improvements in detail, with their respective values.

by the Commissioner, on behalf of the  
prior, in the presence of  
*M. J. Macdonald*  
*Inspector*

*J. P. ...*  
COMMISSIONER OF CROWN LANDS.

Supporting Evidence for Removal

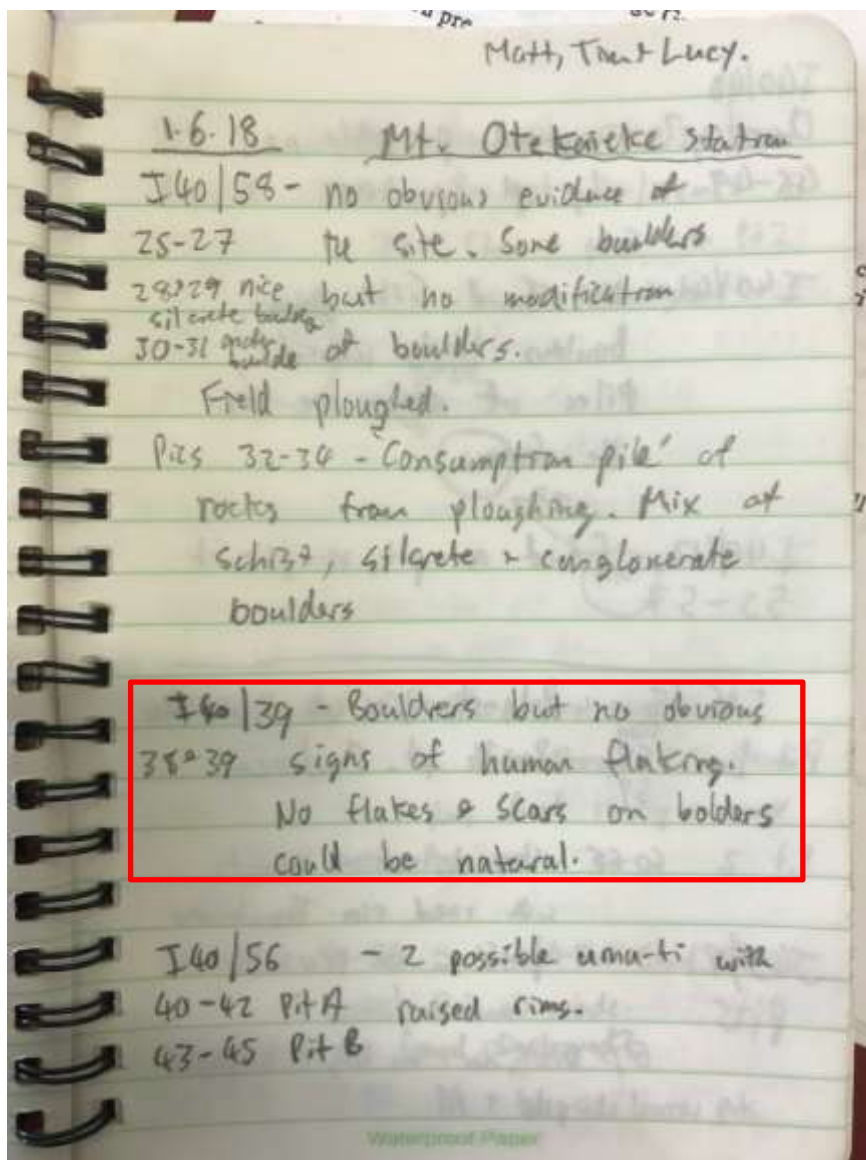

Figure 6: Excerpt from Dr Matthew Schmidt's field book, 1 June 2018 showing recording of site I40/39



NEW ZEALAND ARCHAEOLOGICAL ASSOCIATION		NZAA NZMS 1 SITE NUMBER S127/127	
<b>SITE RECORD FORM (NZMS 1)</b>		DATE VISITED 13-1-80	
NZMS 1 map number S127		SITE TYPE QUARRY	
NZMS 1 map name DUNTRON.		SITE NAME: MAORI <del>POUNGA</del> OTEKAIKE	
NZMS 1 map edition 3 RD. 1978		<del>OTHER</del>	
Grid Reference		Easting 4 1 4 8 0 0, Northing 3 9 8 0 0 0,	
1. Aids to relocation of site (attach a sketch map)			
SITE IS ON RIDGE IMMEDIATELY SOUTHEAST OF BOUNDARY FENCE BETWEEN "LONE HILL" AND "MT OTEKAIKE" STATIONS. HIGH TENSION POWER LINES <sup>OVER</sup> OVER HEAD. (Pylon <del>134</del> IS JUST EAST OF SITE). AND A FARM ROAD ENDS AT THIS RIDGE, AFTER COMMENCING AT DOCTOR'S CREEK RD, ABOUT 400m BEFORE THE FARMHOUSE.			
2. State of site and possible future damage			
GOOD - SLIGHT AS THIS AREA IS NOT PLOUGHED BECAUSE OF THE ORTHO QUARTZITE OUF CROP.			
3. Description of site (Supply full details, history, local environment, references, sketches, etc. If extra sheets are attached, include a summary here)			
LARGE ORTHO (SILICATE) BOULDERS ARE DOTTED AROUND COVERING AN AREA OF APPROXIMATELY 0.25 <sup>HA</sup> SEVERAL BOULDERS MEASURE IN EXCESS OF 1M AND DISPLAY SIGNS OF FLAKING. AT LEAST THREE CIRCULAR DEPRESSIONS MEASURING BETWEEN 2m to 2.5m IN DIAMETER AND UP TO 60cm DEEP APPEAR TO INDICATE QUARRYING ACTIVITIES, ALTHOUGH ONE MAY BE AN OVEN. EXTREME GROWING CONDITIONS HAVE RESULTED IN A DENSE GRASS COVER AND NO FLAKES WERE OBSERVED. HOWEVER SEVERAL (SIX WERE <del>COMPLETED</del> IN ONE "HOLE"). SILICATE ROCKS (MEASURING ABOUT 20 to 30 cm IN DIAMETER) HERECORDED IN THE BOTTOM OF THESE DEPRESSIONS AND SOME AT LEAST APPEARED TO BE REJECTED CORES.			
4. Owner		Tenant/Manager	
Address MR G. BISHOP MT. OTEKAIKE STATION, DOCTOR'S CREEK, DUNTRON.		Address	
5. Nature of information (hearsay, brief or extended visit, etc.) EXTENDED VISIT			
Photographs (reference numbers, and where they are held) -			
Aerial photographs (reference numbers, and clarity of site) -			
6. Reported by B.A. VINCENT, Address C/O ANTHRO. DEPT., O.U.		Filekeeper <i>wj Vincent</i> Date 1/2/80  FN. 11.	
7. Key words QUARRY   SILICATE			
B. New Zealand Register of Archaeological Sites (for office use) NZHPT Site Field Code			
AN	Type of site	AB	Present condition and future danger of destruction
AW	Local environment today	AA	Security code
AC	Land classification	EN	Local body

